

Curtain Track

Fitting Instructions

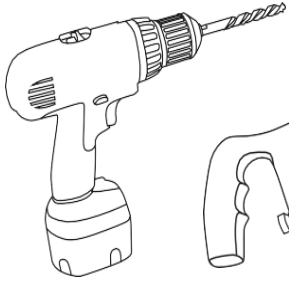

Tools you may need...



Drill

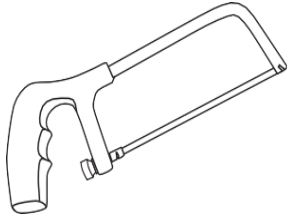

Hacksaw

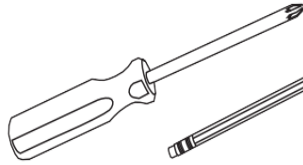

Screwdriver



Pencil

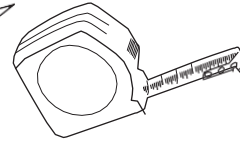

Tape Measure

how to...

fit your curtain track...

The box will include your track at the length ordered, brackets and fixings.
This track is for use with pinch pleat curtains.

When you measured for your track you will have decided its position and whether you were fitting to the ceiling or directly onto the wall. The brackets for this track are universal and will suit both positions.

Step 1: Determine the position of your track brackets. We advise that the 2 outer brackets are 10cm from the end of the track, and all other brackets are spaced evenly (no further than 60cm apart) between these 2 outer brackets.

Step 2: Mark out with a pencil where you want to fit the brackets; use the brackets as a template to identify your screw points. You may want to use a straight edge or chalk-line for accuracy.

Tip 1: Your track should be central to the window / door recess; leave an equal gap or overhang on both sides.

Tip 2: Your track should be fitted at the point chosen when measured; maybe using the drop of your curtains, work upwards to find your installation height. Don't forget to allow for the track depth.

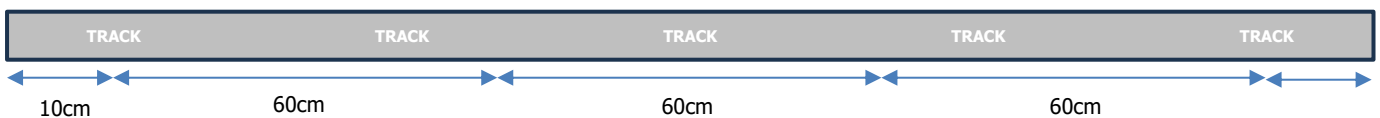

Step 3: Drill into the wall / ceiling at the marked positions with an appropriate drill bit for the type of wall / ceiling, to a minimum depth of 40mm. Insert the plugs and push / hammer home until flush with the wall / ceiling. Then screw each bracket into position using the screw provided.

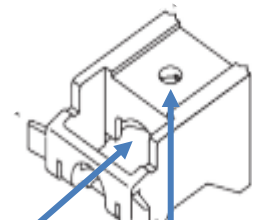

Step 4: Click the track onto the fitted brackets and tap into position gently to centralise across the window.

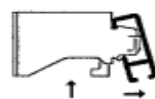
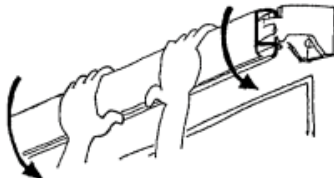

Removal push upwards and forwards.

Step 5: To remove the track, gently push the release button at the rear of the track up and unlock by twisting the track gently forward from the bottom. Always remove the curtains from the track before carrying out this step.

Note: If for some reason you need to shorten your track, remove one of the end caps and cut down the track with a sharp hacksaw - taking care to cut as squarely as possible. Replace the end cap once you have finished.

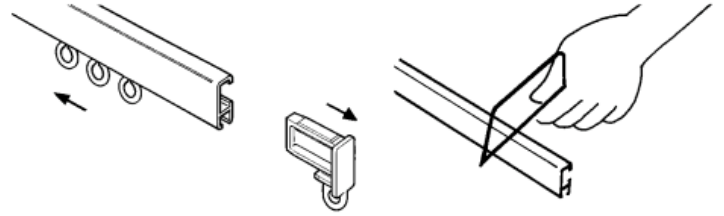

Maintenance and Cleaning

This track and its components must not be treated with aggressive cleaning products. It is best cleaned with a slightly damp cloth only.



Just Furnishings Limited

customerservice@justfurnishings.co.uk | Highlands Road, Solihull, West Midlands, B90
4NP

www.justfurnishings.co.uk

Company Reg: 05998499